

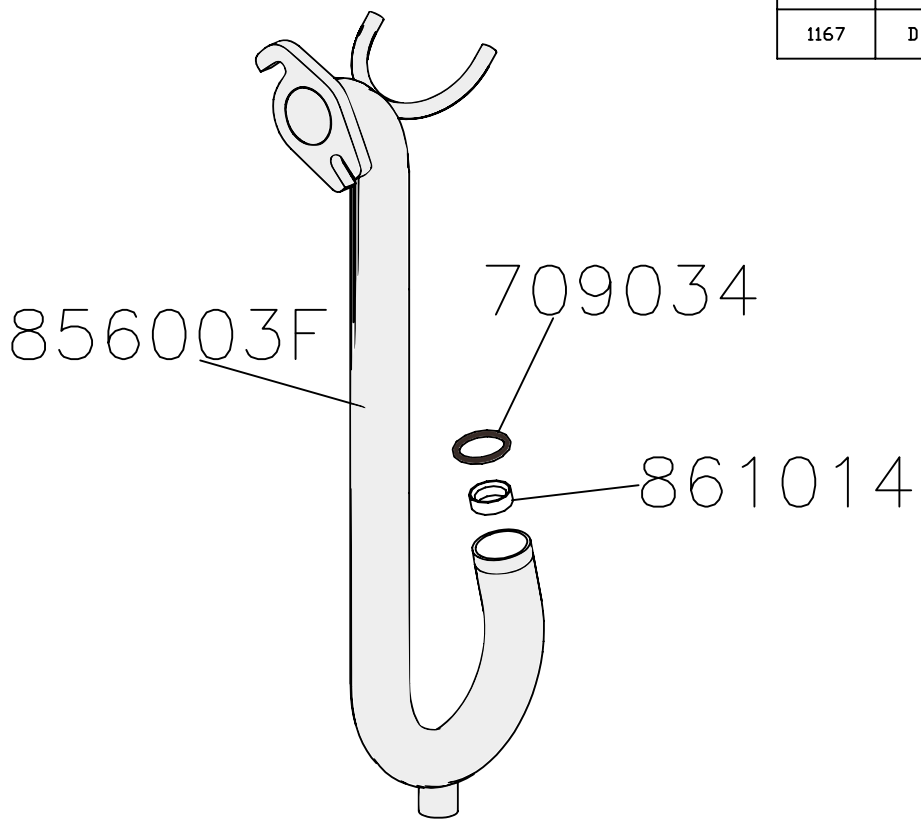

REVISIONS

| ECN  | REV | DESCRIPTION                                | DATE  | BY  |
|------|-----|--|-------|-----|
| 977  | A   | RELEASED                                   | 10/99 | MWJ |
| 1092 | B   | CHANGE FROM 85TT TO 85T, 856003 TO 856003F | 12/00 | HM  |
| 1113 | C   | ADD NOTE                                   | 01/01 | HM  |
| 1167 | D   | REMOVE NOTE                                | 05/01 | MWJ |



|   |        |       |
|---|--------|-------|
|   | BY     | DATE  |
| DRAWN   | MWJ    | 09/01 |
| CHKD  | D.J.C. | 9/01  |
| APPVD   |        |       |
| ALL DIMENSIONS IN INCHES<br>UNLESS OTHERWISE NOTED                    |        |       |
| TOLERANCES UNLESS NOTED<br>XX ± 0.010<br>XXX ± 0.005<br>ANGLES ± 1/2° |        |       |
| MATERIAL  |        |       |

# Gooseneck Assy



|                   |       |                |          |
|-------------------|-------|----------------|----------|
| SIZE<br>A         | SCALE | DWG NO.<br>85T | REV<br>D |
| ASSEMBLY REF. NO. |       | SHEET          |          |



| <b>Part Number</b> | <b>Description</b>  | <b>Quantity Each</b> |
|--------------------|---------------------|----------------------|
| 709034             | O'Ring 568-210 Buna | 1                    |
| 856003F            | Gooseneck Assembly  | 1                    |
| 861014             | Gooseneck Spacer    | 1                    |